

ALLURE OF SANT JORDI BY TM 2ª FASE

Mallorca / Colonia de Sant Jordi

URBANISATION



Apartments and duplex penthouses with 3 bedrooms in Colonia de Sant Jordi

Allure of Sant Jordi by TM is located in Colonia de Sant Jordi, 300 metres from the beaches Els Estanys and Es Trenc. This residential will have 4 homes of different types: apartments with gardens with 3 bedrooms and 3 bathrooms and duplex penthouses with solarium with 3 bedrooms and 3 bathrooms.

THE SURROUNDING AREA



The Beaches

Allure of Sant Jordi by TM is located only 100 metres from the Mediterranean Sea. Within 200 metres, there are two coves, Es Marques cove and Sa Bassa des Cabots cove. And just 300 metres from the residential, there are the emblematic beaches, Els Estanys beach and Es Trenc beach, both famous for their crystal clear turquoise waters, white sands and next to the Es Trenc - Salobrar Natural Park. Es Trenc beach is more than 2 kilometres long with pine woods, dunes and salt marshes in the background in a protected natural environment.

Golf courses

The Port of Colonia de Sant Jordi offers you the possibility to rent a boat and enjoy the crystal clear turquoise waters of the island of Mallorca, where you can sail and discover the most beautiful corners of the Mediterranean Sea! You can even go to the island of Cabrera and fall in love with its National Park. If, on the other hand, you are a golf enthusiast, there are several golf courses Vall D'Or, Maioris and Son Antem about 25 kilometres away.

Amenities

Colonia de Sant Jordi is one of the most picturesque villages in Mallorca. In the past, this village was known for its fishing tradition and for the Salinas de S'Avall, one of the oldest in the world, and very beautiful due to its characteristic pink colour. A place where you can let yourself be captivated by the beauty of its sunsets with the Salinas de S'Avall and the island of Cabrera on the horizon. A promenade along the coastline of Colonia de Sant Jordi with a port, a wide range of services and leisure activities: restaurants, several supermarkets, a school, a car hire service and a weekly street market with food, flowers, clothes and handicrafts. A picturesque village with a lot of charm.

PLANS

ALLURE
of SANT JORDI s.m.

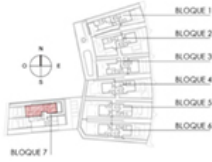

Nº	SUPERFICIES ÚTILES / FLOOR AREA / NUTZFLÄCHE	TPO TYPE TYP	Q0
1	VESTIBULO / HALL / VESTIBULE		4,66 m2
2	PASO 1 / CORRIDOR 1 / DURCHGANG 1		3,38 m2
3	PASO 2 / CORRIDOR 2 / DURCHGANG 2		2,29 m2
6	COCINA / KITCHEN / KÜCHE		9,39 m2
7	GALERIA / GALLERY / WIRTSCHAFTSRAUM		4,78 m2
8	SALÓN COMEDOR / LIVING DINING ROOM / WOHN ESSENZIMMER		33,67 m2
9	DORMITORIO 1 / BEDROOM 1 / SCHLAFZIMMER 1		17,84 m2
10	DORMITORIO 2 / BEDROOM 2 / SCHLAFZIMMER 2		16,18 m2
11	DORMITORIO 3 / BEDROOM 3 / SCHLAFZIMMER 3		13,89 m2
12	BAÑO 1 / BATHROOM 1 / BADEZIMMER 1		6,48 m2
13	BAÑO 2 / BATHROOM 2 / BADEZIMMER 2		6,31 m2
14	TRASTERO / STOREROOM / ABSTELLRAUM		3,42 m2
24	BAÑO 3 / BATHROOM 3 / BADEZIMMER 3		4,84 m2
32	MUEBLE ZAPATERO / SHOE CABINET / SCHUHSCHRANK		0,88 m2
TOTAL SUP. ÚTILES / TOTAL FLOOR AREA / GESAMTE NUTZFLÄCHE			124,04 m2
SUP. CONSTRUIDA INTERIOR / BUILT INTERIOR AREA / BEBAUTE INNENFLÄCHE			147,83 m2
16	SUP. CONSTRUIDA PORCHE 1 / BUILT PORCH 1 AREA / BEBAUTE VORHALLE 1		22,34 m2
TOTAL SUP. CONSTRUIDA PRIVADA / TOTAL BUILT PRIVATE AREA / GESAMTE BEBAUTE FLÄCHE			169,87 m2
SUP. JARDIN / GARDEN AREA / GARTENFLÄCHE			123 m2

TM
TM Grupo Inmobiliario



TIPO / TYPE / TYP O0

Apartamento 3 Dormitorios + 3 Baños - Planta Baja
Apartment 3 Bedrooms + 3 Bathrooms - Ground Floor
Apartment 3 Schlafzimmer + 3 Badezimmer - Erdgeschoss

0 1 2 3 4 5

MARZO/MARCH/MARSCH 2024

Plano sujeto a posibles modificaciones por razones o exigencias de índole técnica o jurídica. Las superficies son aproximadas. Contra y ambientamiento construido, sin valor contractual.
Plan subject to possible modifications for technical or legal reasons. Measurements shown are approximate. Kitchen and furniture are for display purposes only, with no contractual value.
Plan unterliegt möglichen Änderungen aus technischen oder rechtlichen Gründen. Die Flächen und die Küche und möblierung sind ohne vertraglichen Wert.

ALLURE
of SANT JORDI s.m.

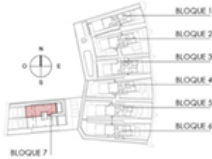

Nº	SUPERFICIES ÚTILES / FLOOR AREA / NUTZFLÄCHE	TPO TYPE TYP	Q1
1	VESTIBULO / HALL / VESTIBULE		5,38 m2
2	PASO / CORRIDOR / DURCHGANG		4,48 m2
6	COCINA / KITCHEN / KÜCHE		11,27 m2
7	GALERIA / GALLERY / WIRTSCHAFTSRAUM		9,34 m2
8	SALÓN COMEDOR / LIVING DINING ROOM / WOHN ESSENZIMMER		39,82 m2
9	DORMITORIO 1 / BEDROOM 1 / SCHLAFZIMMER 1		27,83 m2
10	DORMITORIO 2 / BEDROOM 2 / SCHLAFZIMMER 2		16,87 m2
11	DORMITORIO 3 / BEDROOM 3 / SCHLAFZIMMER 3		13,75 m2
12	BAÑO 1 / BATHROOM 1 / BADEZIMMER 1		6,89 m2
13	BAÑO 2 / BATHROOM 2 / BADEZIMMER 2		4,84 m2
14	TRASTERO / STOREROOM / ABSTELLRAUM		3,42 m2
15	ESCALERA 1 / STAIRS 1 / TREPPEN 1		7,84 m2
30	ASEO / WC / WC		3,39 m2
TOTAL SUP. ÚTILES / TOTAL FLOOR AREA / GESAMTE NUTZFLÄCHE			163,89 m2
SUP. CONSTRUIDA INTERIOR / BUILT INTERIOR AREA / BEBAUTE INNENFLÄCHE			197,61 m2
16	SUP. CONSTRUIDA TERRAZA 1 / BUILT TERRACE 1 AREA / BEBAUTE TERRASSE 1		45,19 m2
19	SUP. CONSTRUIDA TERRAZA 2 / BUILT TERRACE 2 AREA / BEBAUTE TERRASSE 2		27,64 m2
20	SUP. CONSTRUIDA SOLARIUM / BUILT SOLARIUM AREA / BEBAUTE DACHTERRASSENFLÄCHE		108,83 m2
22	SUP. CONSTRUIDA DE TERRAZA DESCUBIERTA 1 / BUILT OPEN TERRACE 1 AREA / BEBAUTE TERRASSE 1		38,89 m2
29	SUP. CONSTRUIDA DE TERRAZA DESCUBIERTA 2 / BUILT OPEN TERRACE 2 AREA / BEBAUTE TERRASSE 2		28,16 m2
34	SUP. CONSTRUIDA TERRAZA 3 / BUILT TERRACE 3 AREA / BEBAUTE TERRASSE 3		16,36 m2
TOTAL SUP. CONSTRUIDA PRIVADA / TOTAL BUILT PRIVATE AREA / GESAMTE BEBAUTE FLÄCHE			465,36 m2

TM
TM Grupo Inmobiliario



PLANTA SOLARIUM



PLANTA SEGUNDA



PLANTA PRIMERA

TIPO / TYPE / TYP Q1

Dúplex con solarium y 3 Dormitorios + 3 Baños - Planta Primera + Planta segunda + Solarium
Duplex with solarium and 3 Bedrooms + 3 Bathrooms - First floor + Second floor + Solarium
Duplex mit solarium und 3 Schlafzimmer + 3 Badezimmer - Erster Etage + Zweiter Etage + Solarium

0 1 2 3 4 5

MARZO/MARCH/MARSCH 2024

Plano sujeto a posibles modificaciones por razones o exigencias de índole técnica o jurídica. Las superficies son aproximadas. Contra y ambientamiento construido, sin valor contractual.
Plan subject to possible modifications for technical or legal reasons. Measurements shown are approximate. Kitchen and furniture are for display purposes only, with no contractual value.
Plan unterliegt möglichen Änderungen aus technischen oder rechtlichen Gründen. Die Flächen und die Küche und möblierung sind ohne vertraglichen Wert.

AERIAL VIEW



PLAN OF THE COMPLEX





PROPERTIES AVAILABLE

Type	Bedrooms	Bathrooms	Price range	m2
Apartment	3	3	850.000€	169



Solicita información en la oficina de venta TM más cercana a tu domicilio o ponte en contacto con nosotros en el teléfono **902 15 15 12** o en la dirección de email **comercial@tmgrupoinmobiliario.com**

TM GRUPO INMOBILIARIO