

ALLURE OF SANT JORDI BY TM 1ª FASE

Mallorca / Colonia de Sant Jordi

URBANISATION



Apartments, duplex and penthouses with 2 and 3 bedrooms in Colonia de Sant Jordi

Allure of Sant Jordi by TM is located in Colonia de Sant Jordi, 300 metres from the beaches Els Estanys and Es Trenc, and next to the Salinas de S'Avall. This residential will have 24 homes of different types: apartments with large gardens and terraces, penthouses with solarium, and duplex with gardens.

THE SURROUNDING AREA



The Beaches

Allure of Sant Jordi by TM is located only 100 metres from the Mediterranean Sea. Within 200 metres, there are two coves, Es Marques cove and Sa Bassa des Cabots cove. And just 300 metres from the residential, there are the emblematic beaches, Els Estanyes beach and Es Trenc beach, both famous for their crystal clear turquoise waters, white sands and next to the Es Trenc - Salobrar Natural Park. Es Trenc beach is more than 2 kilometres long with pine woods, dunes and salt marshes in the background in a protected natural environment.

Golf courses

The Port of Colonia de Sant Jordi offers you the possibility to rent a boat and enjoy the crystal clear turquoise waters of the island of Mallorca, where you can sail and discover the most beautiful corners of the Mediterranean Sea! You can even go to the island of Cabrera and fall in love with its National Park. If, on the other hand, you are a golf enthusiast, there are several golf courses Vall D'Or, Maioris and Son Antem about 25 kilometres away.

Amenities

Colonia de Sant Jordi is one of the most picturesque villages in Mallorca. In the past, this village was known for its fishing tradition and for the Salinas de S'Avall, one of the oldest in the world, and very beautiful due to its characteristic pink colour. A place where you can let yourself be captivated by the beauty of its sunsets with the Salinas de S'Avall and the island of Cabrera on the horizon. A promenade along the coastline of Colonia de Sant Jordi with a port, a wide range of services and leisure activities: restaurants, several supermarkets, a school, a car hire service and a weekly street market with food, flowers, clothes and handicrafts. A picturesque village with a lot of charm.

PLANS

ALLURE
of SANT JORDI by TM

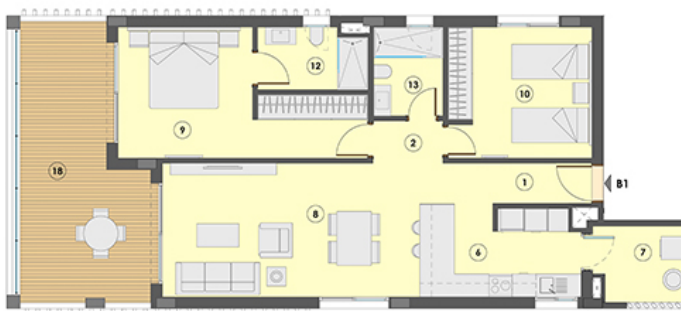
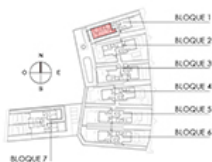

Nº	SUPERFICIES ÚTILES / FLOOR AREA / NUTZFLÄCHE	TIPO / TYPE / TYP	B1
1	VESTIBULO / HALL / VESTIBULE	2,89 m ²	
2	PASO / CORRIDOR / DURCHGANG	2,06 m ²	
6	COCINA / KITCHEN / KÜCHE	8,82 m ²	
7	GALLERIA / GALLERY / WIRTSCHAFTSTRAUM	4,47 m ²	
8	SALÓN COMEDOR / LIVING DINING ROOM / WOHN-ESSZIMMER	25,22 m ²	
9	DORMITORIO 1 / BEDROOM 1 / SCHLAFZIMMER 1	16,28 m ²	
10	DORMITORIO 2 / BEDROOM 2 / SCHLAFZIMMER 2	12,87 m ²	
12	BANO 1 / BATHROOM 1 / BADEZIMMER 1	4,45 m ²	
13	BANO 2 / BATHROOM 2 / BADEZIMMER 2	4,14 m ²	
TOTAL SUP. ÚTILES / TOTAL FLOOR AREA / GESAMTE NUTZFLÄCHE		82,94 m ²	
SUP. CONSTRUIDA INTERIOR / BUILT INTERIOR AREA / BEBAUTE INNENFLÄCHE		58,19 m ²	
18	SUP. CONSTRUIDA TERRAZA / BUILT TERRACE AREA / BEBAUTE TERRASSE	25,32 m ²	
TOTAL SUP. CONSTRUIDA PRIVADA / TOTAL BUILT PRIVATE AREA / GESAMTE BEBAUTE FLÄCHE		122,11 m ²	

TIPO / TYPE / TYP B1

Apartamento 2 Dormitorios + 2 Baños - Planta primera
Apartment 2 Bedrooms + 2 Bathrooms - First floor
Apartment 2 Schlafzimmer + 2 Badezimmer - Erster Etage



MARZO/MARCH/MARSCH 2024

Plans subject to possible modifications for technical or legal reasons. Measurements shown are approximate. Kitchen and terracing are for display purposes only, with no contractual value. Plan unterliegt möglichen Änderungen aus technischen oder rechtlichen Gründen. Die Flächen sind zu Küche und Terrasse nur als Richtlinie und nicht als verbindlicher Maßstab.

ALLURE
of SANT JORDI by TM

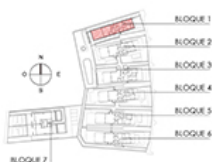

PLANTA SOLARIUM

Nº	SUPERFICIES ÚTILES / FLOOR AREA / NUTZFLÄCHE	TIPO / TYPE / TYP	C2
1	VESTIBULO / HALL / VESTIBULE	7,41 m ²	
2	PASO / CORRIDOR / DURCHGANG	8,48 m ²	
6	COCINA / KITCHEN / KÜCHE	9,29 m ²	
7	GALLERIA / GALLERY / WIRTSCHAFTSTRAUM	4,63 m ²	
8	SALÓN COMEDOR / LIVING DINING ROOM / WOHN-ESSZIMMER	35,99 m ²	
9	DORMITORIO 1 / BEDROOM 1 / SCHLAFZIMMER 1	16,28 m ²	
10	DORMITORIO 2 / BEDROOM 2 / SCHLAFZIMMER 2	12,77 m ²	
11	DORMITORIO 3 / BEDROOM 3 / SCHLAFZIMMER 3	11,36 m ²	
12	BANO 1 / BATHROOM 1 / BADEZIMMER 1	6,37 m ²	
13	BANO 2 / BATHROOM 2 / BADEZIMMER 2	3,86 m ²	
14	TRASTERO / STOREROOM / ABSTELLRAUM	2,26 m ²	
15	ESCALERAS / STAIRS / TREPPEN	5,26 m ²	
30	ASEO / W.C. / WC	2,54 m ²	
TOTAL SUP. ÚTILES / TOTAL FLOOR AREA / GESAMTE NUTZFLÄCHE		122,59 m ²	
SUP. CONSTRUIDA INTERIOR / BUILT INTERIOR AREA / BEBAUTE INNENFLÄCHE		101,14 m ²	
SUP. CONSTRUIDA SOLARIUM 1 / BUILT SOLARIUM 1 AREA / BEBAUTE SOLARIUMFLÄCHE 1		147,33 m ²	
SUP. CONSTRUIDA DE TERRAZA DESCUBERTA 1 / BUILT OPEN TERRACE 1 AREA / BEBAUTE TERRASSE 1		61,68 m ²	
SUP. CONSTRUIDA DE TERRAZA DESCUBERTA 2 / BUILT OPEN TERRACE 2 AREA / BEBAUTE TERRASSE 2		14,29 m ²	
SUP. CONSTRUIDA DE TERRAZA DESCUBERTA 3 / BUILT OPEN TERRACE 3 AREA / BEBAUTE TERRASSE 3		6,82 m ²	
TOTAL SUP. CONSTRUIDA PRIVADA / TOTAL BUILT PRIVATE AREA / GESAMTE BEBAUTE FLÄCHE		378,88 m ²	

PLANTA SEGUNDA



MARZO/MARCH/MARSCH 2024

Plans subject to possible modifications for technical or legal reasons. Measurements shown are approximate. Kitchen and terracing are for display purposes only, with no contractual value. Plan unterliegt möglichen Änderungen aus technischen oder rechtlichen Gründen. Die Flächen sind zu Küche und Terrasse nur als Richtlinie und nicht als verbindlicher Maßstab.

AERIAL VIEW



PLAN OF THE COMPLEX





PROPERTIES AVAILABLE

Type	Bedrooms	Bathrooms	Price range	m2
Apartment	2	2	560.000€ - 695.000€	118 - 191
Apartment	3	3	970.000€ - 995.000€	379 - 408
Duplex	3	3	824.000€ - 925.000€	229 - 289



Solicita información en la oficina de venta TM más cercana a tu domicilio o ponte en contacto con nosotros en el teléfono **902 15 15 12** o en la dirección de email **comercial@tmgrupoinmobiliario.com**

TM GRUPO INMOBILIARIO