

DREAM GARDENS

Costa del Sol / Cala de Mijas (Málaga)

URBANISATION



Luxury properties in La Cala de Mijas.

With a prime location in La Cala de Mijas, Dream Gardens is ideally situated within easy walking distance of the beach and all essential services. The luxury feel of the properties extends to the complex's facilities, with an outdoor infinity pool, chill-out zone and Balinese loungers, spa with indoor heated pool, Finnish sauna and Turkish bath, fully-equipped gym, wine cellar and Wi-Fi throughout the common areas. The contemporary architecture of the development and each individual property provides maximum comfort while allowing you to enjoy a relaxed, healthy lifestyle in the heart of the Costa del Sol.

OPTIONAL FURNISHINGS



We offer you the possibility to enjoy your new home from the moment you walk in the door, with all furniture, furnishings, white goods, kitchenware, crockery, cutlery, household linens, television, etc....So that you don't have to worry about a thing!

THE SURROUNDING AREA



The Beaches

La Cala de Mijas beach is just 500 metres from the complex. Gorgeous coves and beaches are dotted all along this stretch of the coast.

Golf courses

The area around Dream Gardens is known as “Golf Valley”. A paradise for golf lovers, there are nine excellent courses nearby, including the renowned 18-hole, par 72 Calanova Golf Club with its captivating design.

Amenities

La Cala de Mijas is just 20 minutes from Málaga international airport. The smart resorts of Marbella and Puerto Banús are just 15 minutes away and are bustling all year round, offering all the amenities and activities needed for a healthy lifestyle.

PLANS

BLOQUE 1 - PLANTA SEGUNDA VIVIENDA 109



SUPERFICIES CONSTRUIDAS

VIVIENDA	118.84 m²
TERRAZA CUBIERTA 1	28.76 m²
TERRAZA CUBIERTA 2	8.34 m²
TOTAL CONST. INTERIOR + TERRAZAS CUB.	155.94 m²
REPARTO DE ZONA COMÚN	14.30 m²
TOTAL CONSTRUIDA + ZONA COMÚN	170.24 m²
TERRAZA DESCUBIERTA 1	8.24 m²
TERRAZA DESCUBIERTA 2	16.67 m²
TOTAL CONSTRUIDA + ZC+TERR. DESCUBIERTAS	195.15 m²

BLOQUE 1 - PLANTA ÁTICO VIVIENDA 110

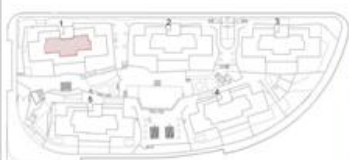

SUPERFICIES CONSTRUIDAS

VIVIENDA	123.33 m²
REPARTO DE ZONA COMÚN	11.31 m²
TOTAL CONSTRUIDA + ZONA COMÚN	134.64 m²
TERRAZA DESCUBIERTA	244.50 m²
TOTAL CONSTRUIDA + ZC+TERR. DESCUBIERTA	379.14 m²
PISCINA	15.00 m²



AERIAL VIEW



PLAN OF THE COMPLEX





PROPERTIES AVAILABLE

Type	Bedrooms	Bathrooms	Price range	m2
Parking	0	0	10.000€ - 15.000€	14 - 22



Solicita información en la oficina de venta TM más cercana a tu domicilio o ponte en contacto con nosotros en el teléfono **902 15 15 12** o en la dirección de email **comercial@tmgrupoinmobiliario.com**

TM GRUPO INMOBILIARIO