

LOS ALTOS DE ALICANTE 5ª FASE

Costa Blanca Norte / Busot, zona
Bonalba Golf (Alicante)

URBANISATION



Semi-detached, and terraced homes in Busot, Alicante

Los Altos de Alicante is located in a natural setting in the foothills of the Sierra del Cabeço d'Or mountains and is also a short distance from the beach. The perfect place to live and enjoy the mountains and the coast. This new phase will include 2- and 3-bedroom detached villas, semi-detached villas, and terraced villas with 2 bathrooms. The residential estate will also benefit from a communal pool, jacuzzi, and garden areas. A fantastic investment!

THE SURROUNDING AREA



The Beaches

The beaches of El Campello and San Juan are only ten minutes away from Los Altos de Alicante 5th Phase. The residents of Busot can enjoy the sea within a short drive from the residential area. Thanks to its excellent location, 20 minutes away by car, you can go to numerous coves with crystal clear waters, such as the famous La Almadrava cove or Tío Ximo cove. Both are great for scuba diving and snorkelling in the depths of the Mediterranean Sea.

Golf courses

The Serra Gelada Natural Park is rich in nature and has exceptional vegetation. There are many hiking routes available for you to enjoy walks along its cliffs, its surroundings and its marvellous views. The Punta del Cavall route is very easy and accessible for the whole family. Cycling enthusiasts can practise their favourite sport in the open air thanks to the number of cycling trails. There are also two golf courses for golf lovers: ten minutes away by car, there is the Bonalba Golf Club in Mutxamel and twenty minutes away by car, Alicante Golf in Playa de San Juan, Alicante. Just a few minutes' drive away, you can enjoy water activities such as sailing, kayaking, diving and snorkelling.

PLANS

Los Altos de Alicante

FASE - 5



#	SUPERFICIES ÚTILES / FLOOR AREA / SURFACES UTILES	TIPO TYPE A
2	PASO 1 / CORRIDOR 1 / CIRCULATION 1	1,83 m ²
7	GALERÍA / GALLERY / GALLERIE	2,21 m ²
8	SALON-COMEDOR-COCINA / LIVING-DINING ROOM-KITCHEN / SALON-SALLE A MANGER-CUISINE	22,38 m ²
9	DORMITORIO 1 / BEDROOM 1 / CHAMBRE 1	11,28 m ²
10	DORMITORIO 2 / BEDROOM 2 / CHAMBRE 2	9,89 m ²
12	BANO 1 / BATHROOM 1 / SALLE DE BAINS 1	4,82 m ²
13	BANO 2 / BATHROOM 2 / SALLE DE BAINS 2	3,99 m ²
TOTAL SUP. ÚTILES / TOTAL FLOOR AREA / TOTAL SURFACES UTILES		55,89 m ²
SUP. CONSTRUIDA INTERIOR / BUILT INTERIOR AREA / SURFACE CONSTRUITE INTERIEUR		66,92 m ²
16	SUP. CONSTRUIDA PORCHE 1 / BUILT PORCH 1 AREA / SURFACE CONSTRUITE PORCHE 1	7,12 m ²
17	SUP. CONSTRUIDA PORCHE 2 / BUILT PORCH 2 AREA / SURFACE CONSTRUITE PORCHE 2	1,99 m ²
22	SUP. CONSTRUIDA TERRAZA DESCUBIERTA 1 / BUILT OPEN TERRACE AREA 1 / SURFACE CONSTRUITE TERRASSE NON COUVERTE 1	16,76 m ²
TOTAL SUP. CONSTRUIDA PRIVADA / TOTAL BUILT PRIVATE AREA / TOTAL SURFACE CONSTRUITE PRIVATE		91,86 m ²
SUP. JARDIN desde hasta / GARDEN AREA from to / SURF. JARDIN de a		93 - 183 m ²

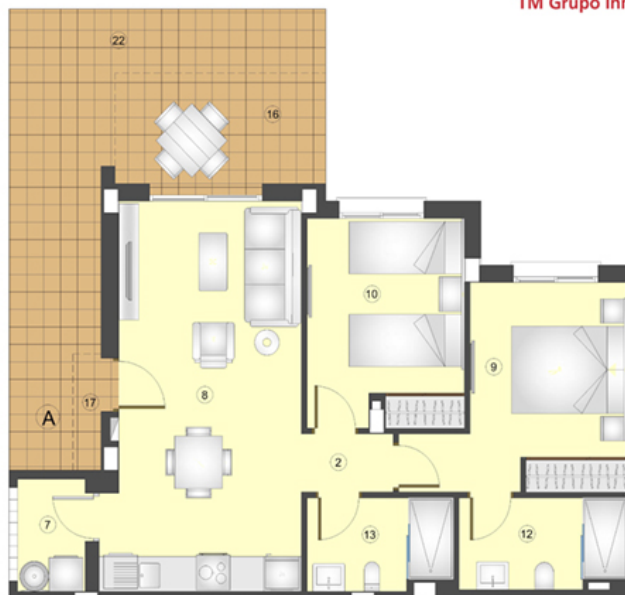

TIPO/TYPE/TYPE A

JUNIO / JUNE / JUIN 2022

Chalet Paredado 2 Dormitorios + 2 baños
Semi-detached Chalet 2 Bedrooms + 2 Bathrooms
Chalet semi-décollé 2 Chambres + 2 baigns



Plano sujeto a posibles modificaciones por razones o exigencias de índole técnica o jurídica. Las superficies son aproximadas. Contiene un amueblamiento orientativo sin valor contractual.
Plans subject to possible modifications for technical or legal reasons. Measurements shown are approximate. Kitchen and furniture are for illustrative purposes only, with no contractual value.
Plan soumis à modifications en fonction des besoins ou exigences d'ordre technique ou juridique. Les mesures indiquées sont approximatives. Contient un aménagement indicatif sans valeur contractuelle.

Los Altos de Alicante

FASE - 5



#	SUPERFICIES ÚTILES / FLOOR AREA / SURFACES UTILES	TIPO TYPE B
2	PASO 1 / CORRIDOR 1 / CIRCULATION 1	2,43 m ²
3	PASO 2 / CORRIDOR 2 / CIRCULATION 2	8,96 m ²
7	GALERÍA / GALLERY / GALLERIE (180°)	2,44 m ²
8	SALON-COMEDOR-COCINA / LIVING-DINING ROOM-KITCHEN / SALON-SALLE A MANGER-CUISINE	26,74 m ²
9	DORMITORIO 1 / BEDROOM 1 / CHAMBRE 1	11,55 m ²
10	DORMITORIO 2 / BEDROOM 2 / CHAMBRE 2	9,39 m ²
11	DORMITORIO 3 / BEDROOM 3 / CHAMBRE 3	10,11 m ²
12	BANO 1 / BATHROOM 1 / SALLE DE BAINS 1	3,87 m ²
13	BANO 2 / BATHROOM 2 / SALLE DE BAINS 2	4,70 m ²
14	TRASTERO / STOREROOM / CAVE	0,45 m ²
15	ESCALERAS / STAIRS / ESCALIERS	4,90 m ²
TOTAL SUP. ÚTILES / TOTAL FLOOR AREA / TOTAL SURFACES UTILES		78,39 m ²
SUP. CONSTRUIDA INTERIOR / BUILT INTERIOR AREA / SURFACE CONSTRUITE INTERIEUR		101,70 m ²
16	SUP. CONSTRUIDA PORCHE 1 / BUILT PORCH 1 AREA / SURFACE CONSTRUITE PORCHE 1	7,94 m ²
17	SUP. CONSTRUIDA PORCHE 2 / BUILT PORCH 2 AREA / SURFACE CONSTRUITE PORCHE 2	1,90 m ²
22	SUP. CONSTRUIDA TERRAZA DESCUBIERTA 1 / BUILT OPEN TERRACE AREA 1 / SURFACE CONSTRUITE TERRASSE NON COUVERTE 1	17,34 m ²
23	SUP. CONSTRUIDA TERRAZA DESCUBIERTA 2 / BUILT OPEN TERRACE AREA 2 / SURFACE CONSTRUITE TERRASSE NON COUVERTE 2	14,93 m ²
TOTAL SUP. CONSTRUIDA PRIVADA / TOTAL BUILT PRIVATE AREA / TOTAL SURFACE CONSTRUITE PRIVATE		142,51 m ²
SUP. JARDIN desde hasta / GARDEN AREA from to / SURF. JARDIN de a		120-214 m ²



PLANTA BAJA

PLANTA PRIMERA

TIPO/TYPE/TYPE B

JUNIO / JUNE / JUIN 2022

Chalet Paredado 3 Dormitorios + 2 baños
Semi-detached Chalet 3 Bedrooms + 2 Bathrooms
Chalet semi-décollé 3 Chambres + 2 baigns



Plano sujeto a posibles modificaciones por razones o exigencias de índole técnica o jurídica. Las superficies son aproximadas. Contiene un amueblamiento orientativo sin valor contractual.
Plans subject to possible modifications for technical or legal reasons. Measurements shown are approximate. Kitchen and furniture are for illustrative purposes only, with no contractual value.
Plan soumis à modifications en fonction des besoins ou exigences d'ordre technique ou juridique. Les mesures indiquées sont approximatives. Contient un aménagement indicatif sans valeur contractuelle.

AERIAL VIEW



PLAN OF THE COMPLEX

Los Altos de Alicante
FASE - 5

52	PISCINA ADULTOS / ADULT POOL / PISCINE ADULTE
57	ZONA DE TUMBORES / SUNBED AREA/ ZONE DE CHAISES LONGUES
58	INTERRAJA / INFANCIA / ENFERS
90	DUCHAS / SHOWERS / DOUCHES

TM
TM Grupo Inmobiliario



MASTER PLAN-1



JUNIO / JUNE / JUIN 2022

Plano sujeto a posibles modificaciones por razones o exigencias de índole técnica o jurídica. Las superficies son aproximadas.
Plan subject to possible modifications for technical or legal reasons. Measurements shown are approximate.
Plan soumis à modifications en fonction des besoins ou exigences d'ordre technique ou juridique. Les surfaces sont approximatives.



PROPERTIES AVAILABLE

Type	Bedrooms	Bathrooms	Price range	m2
Villa	3	2	355.000€	130



Solicita información en la oficina de venta TM más cercana a tu domicilio o ponte en contacto con nosotros en el teléfono **902 15 15 12** o en la dirección de email **comercial@tmgrupoinmobiliario.com**

TM GRUPO INMOBILIARIO